

# Welcome!

PUBLIC HEARING FOR THE

## Washington Union Station Expansion Project

Supplemental Draft Environmental Impact Statement

JUNE 27, 2023 | [WWW.WUSSTATIONEXPANSION.COM](http://WWW.WUSSTATIONEXPANSION.COM)



U.S. Department of Transportation  
**Federal Railroad Administration**



# A Project to...

Expand and modernize multimodal transportation facilities to meet current and future transportation needs while preserving the historic station building.



**Railroad Growth**



**ADA, Safety,  
and Security**

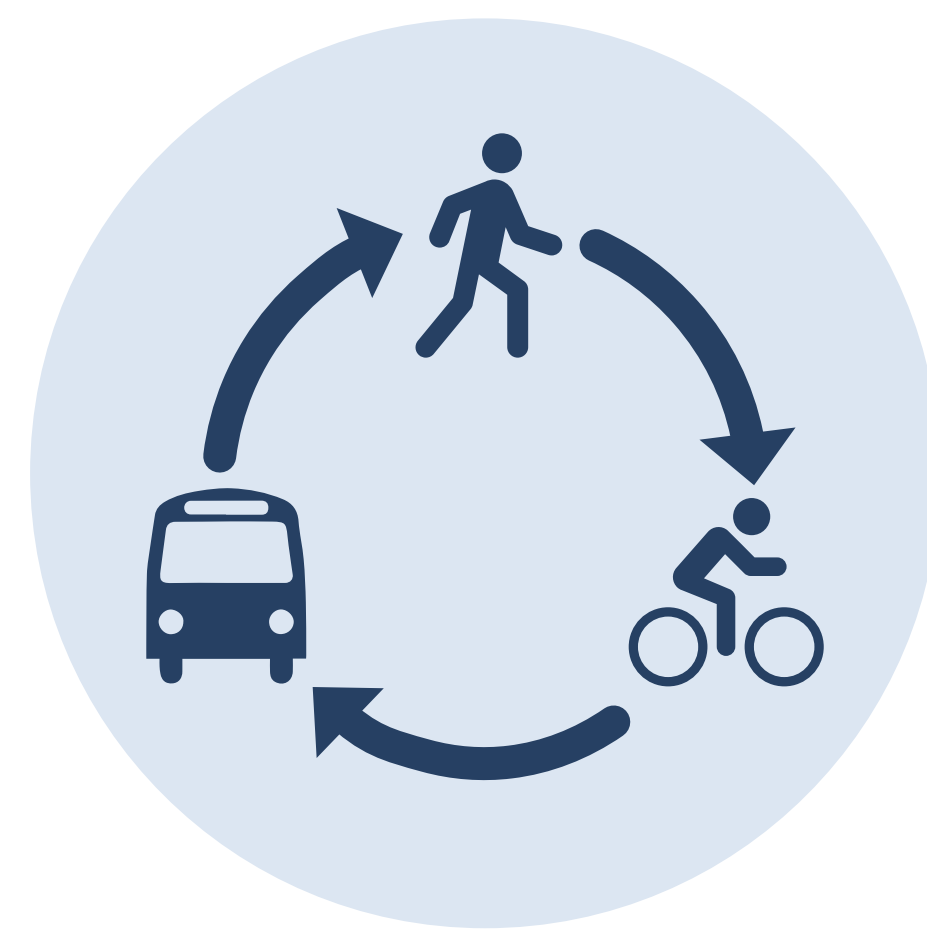

**Intermodal Travel**



**Customer Experience**



**Neighborhoods,  
Land Use, and Integration**



**Station's Economic  
Viability**



**Station Preservation**





# Project Sponsor



UNION STATION  
REDEVELOPMENT CORPORATION

Responsible for implementing the Project through final design  
and construction in coordination with



**LEAD FEDERAL AGENCY:**



U.S. Department of Transportation

**Federal Railroad Administration**



U.S. Department of Transportation  
**Federal Railroad Administration**



# Preferred Alternative

Illustrative Diagram

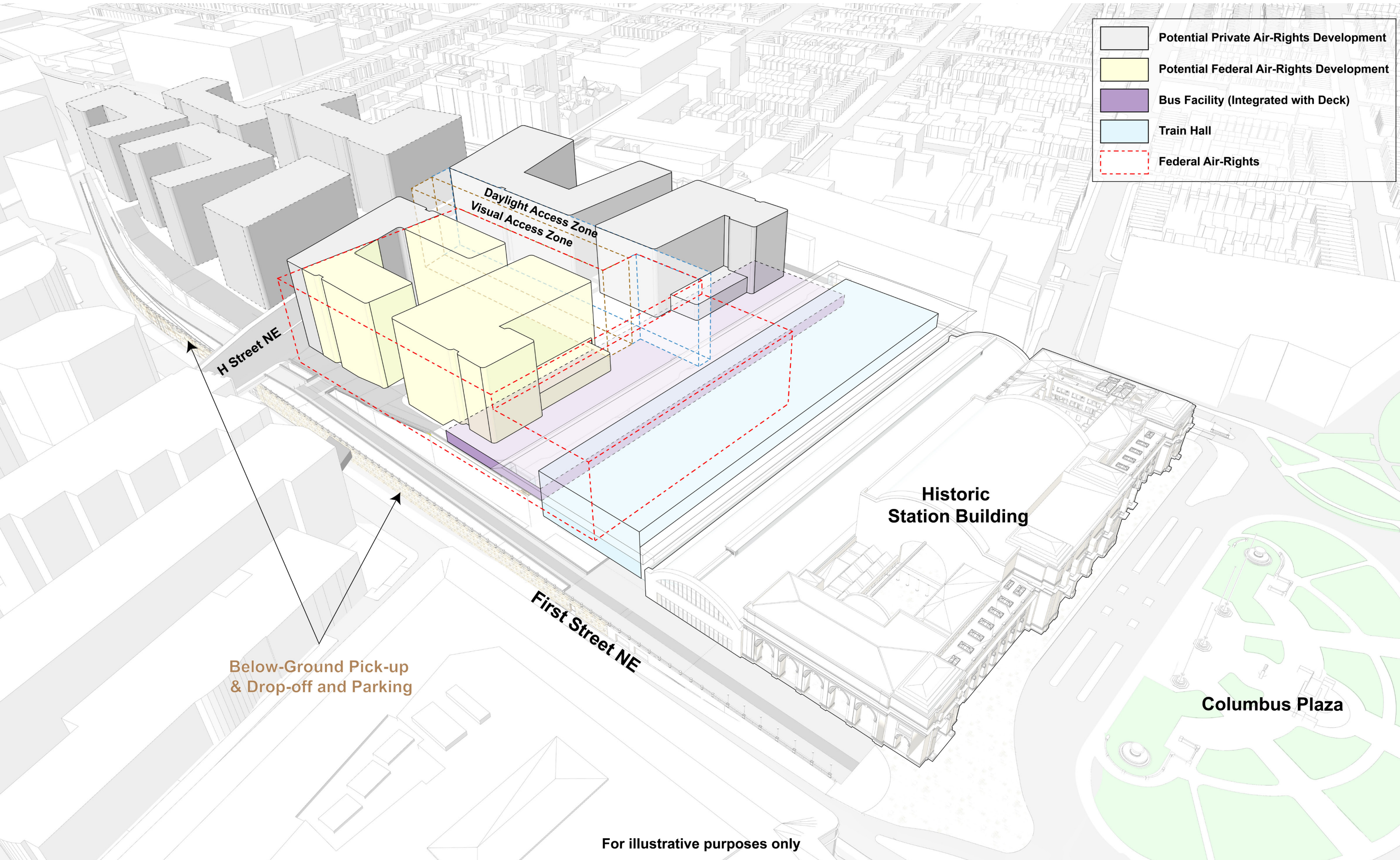

Illustrative Rendering





# Some Major Project Elements\*

Four New Concourses



New Train Hall



New Bus Facility



*\*For illustrative purpose only*



# Some Major Project Elements\*

Below-ground Parking (400–550 spaces)

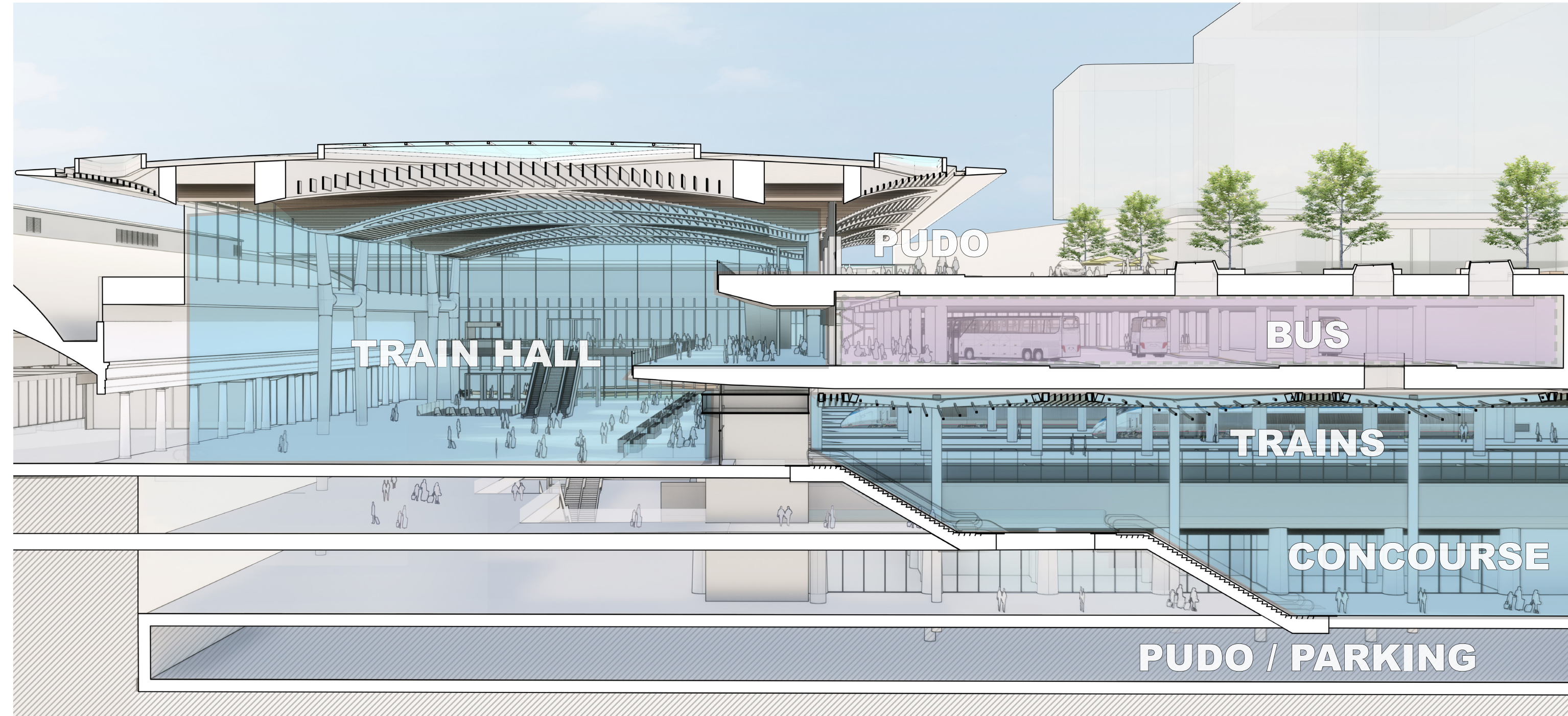

Pick-up & Drop-off Areas



Additional Pedestrian Entrances



*\*For illustrative purpose only*



# Construction Phasing and Duration

Phase	Total Duration	Excavation Duration
Phase 1	2 years, 4 months	5 months
Intermediate Phase	12 months	None
Phase 2	2 years, 8.5 months	10 months
Phase 3	2 years, 8.5 months	11 months
Phase 4	4 years, 3 months	2 years, 1 month
Total	13 years	4 years, 3 months



# Environmental Impact Statement Timeline

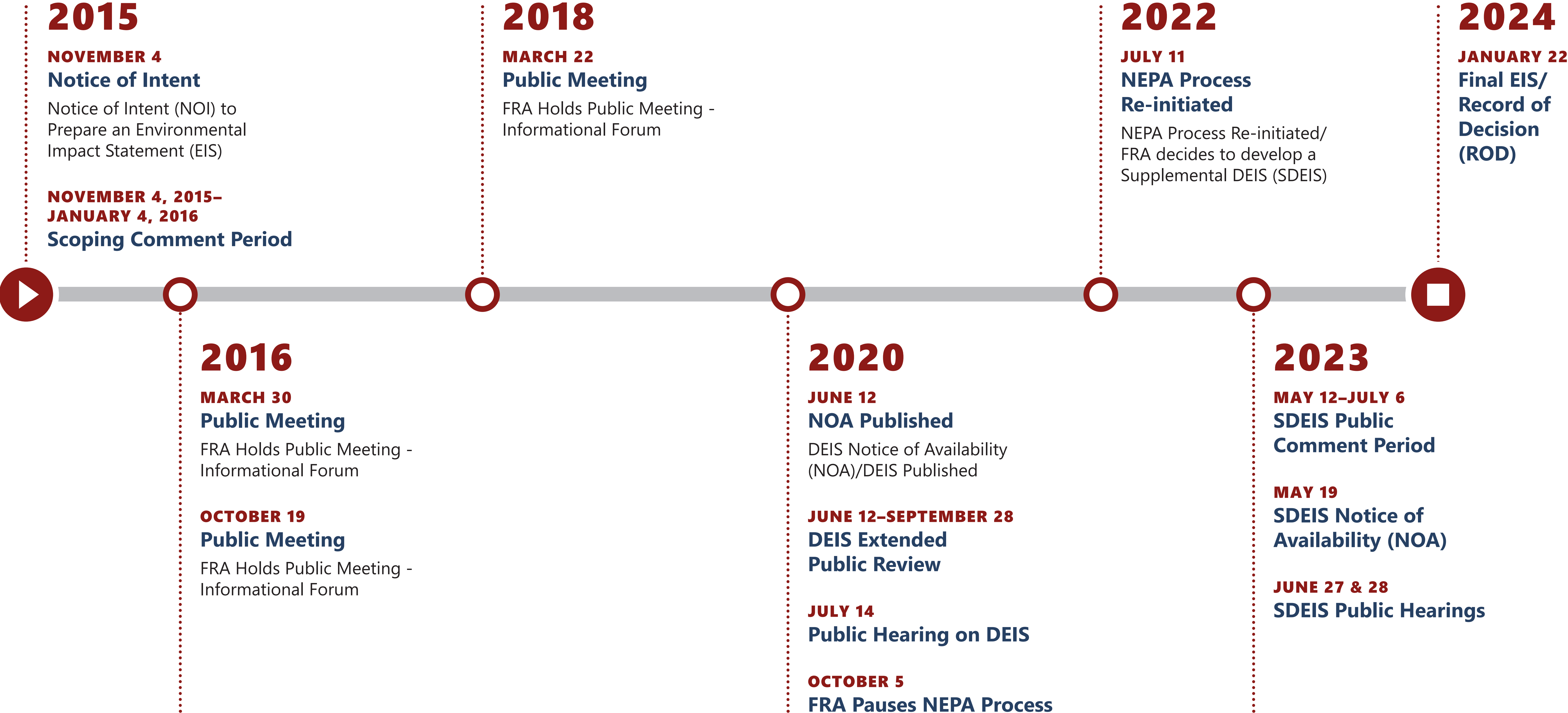



# Contents of the SDEIS

CHAPTER 1	Introduction
CHAPTER 2	Purpose and Need
<b>CHAPTER 3</b>	<b>Alternatives</b>
CHAPTER 4	Affected Environment
<b>CHAPTER 5</b>	<b>Environmental Consequences</b>
CHAPTER 6	Draft Section 4(f) Evaluation
<b>CHAPTER 7</b>	<b>Mitigation Measures and Project Commitments</b>
CHAPTER 8	Public Involvement
CHAPTER 9	Distribution of the DEIS
CHAPTER 10	References
CHAPTER 11	Glossary
CHAPTER 12	Preparers
APPENDICES	<i>Including</i>
<b>APPENDIX D2</b>	<b>Draft Programmatic Agreement</b>





# SDEIS Analysis

## DIRECT, INDIRECT, AND CUMULATIVE IMPACTS ON:

- Natural Ecological Systems
- Water Resources and Water Quality
- Solid Waste Disposal and Hazardous Materials
- Transportation
- Air Quality
- Greenhouse Gas Emissions and Resilience
- Energy Resources
- Land Use, Land Planning, and Property
- Noise and Vibration
- Aesthetics and Visual Quality
- Cultural Resources
- Parks and Recreation Areas
- Social and Economic Conditions
- Public Safety and Security
- Public Health, Elderly and Persons with Disabilities
- Environmental Justice



# Cultural Resources and Section 106

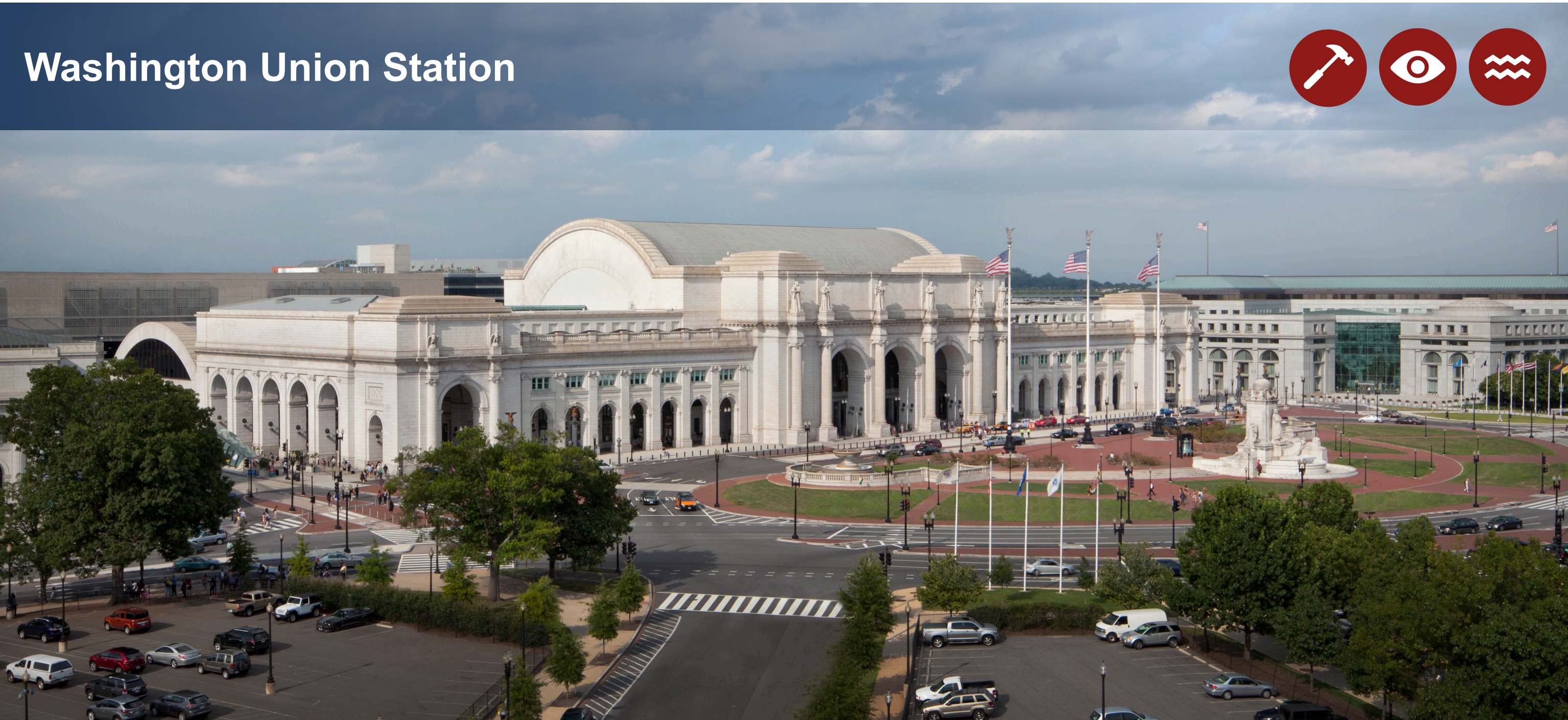

See **Appendix D2 (Draft Programmatic Agreement)** for proposed measures to mitigate adverse effects.

**KEY:** Physical Impacts Visual Impacts Potential Construction Vibration Impacts



# Environmental Justice

- **Potential** for disproportionate impacts from traffic congestion to the northwest of Union Station.
- **Targeted outreach** in February–May 2023 to inform local communities and solicit feedback.
- In SDEIS, FRA anticipates the project would **not** have disproportionately high and adverse impacts on minority or low-income communities.
- FRA will review environmental justice impacts that incorporate **mitigation** and consider public comments and present this information in the FEIS.

