

# WUS Expansion Project EIS

Public Scoping Meeting

December 7, 2015



US Department of Transportation – Federal Railroad Administration

# Introductions



## **FRA**

- Owner of Washington Union Station (WUS)
- Lead Federal Agency for NEPA

## **Union Station Redevelopment Corporation (USRC)**

- Project Proponent - Nonprofit Station complex landlord and public steward

## **Amtrak**

- Intercity and commuter rail infrastructure owner and operator

# Union Station Facts

## Overall Station

- Station handles 37 million visitors as compared to BWI-22.5 million; Dulles-22 million; Reagan-20 million
- 2.6 Million riders/year on intercity buses alone
- 7 modes of transportation available; Nearly 30 transportation providers to choose

## Ridership

- #1 Metro Station for WMATA
- #1 MARC Station
- #2 Amtrak Station in the country
- #2 VRE Station



# Multi-modal Functions

- Amtrak Intercity Rail
- VRE / MARC Commuter Rail
- WMATA – Red Line Station
- Streetcar
- Intercity Bus
- Local Bus
- Tour Bus
- Taxi
- Private Vehicle
- Bicycle



# Union Station – Historic Landmark

## Facts

- Designed by Daniel Burnham and opened in 1908
- Washington Union Station was a consolidation of two depots into one facility allowing for track removal and development of the National Mall
- Listed on the DC Inventory of Historic Sites on November 8, 1964 and listed on the National Register of Historic Places (NRHP) on March 24, 1969
- The project area is adjacent to the Capitol Hill Historic District and in proximity to several historic buildings and structures
- We will be evaluating impacts to both the historic station building itself and surrounding historic properties

# Union Station – Historic Landmark

## Historic Preservation Plan (HPP)

- Completed in 2015
- The HPP establishes an overarching preservation philosophy for Union Station to provide consistency for its stewards during future planning and design processes

# Controlling Interests

- FRA/USRC
- Amtrak
- Akridge
- DDOT
- WMATA
- NPS

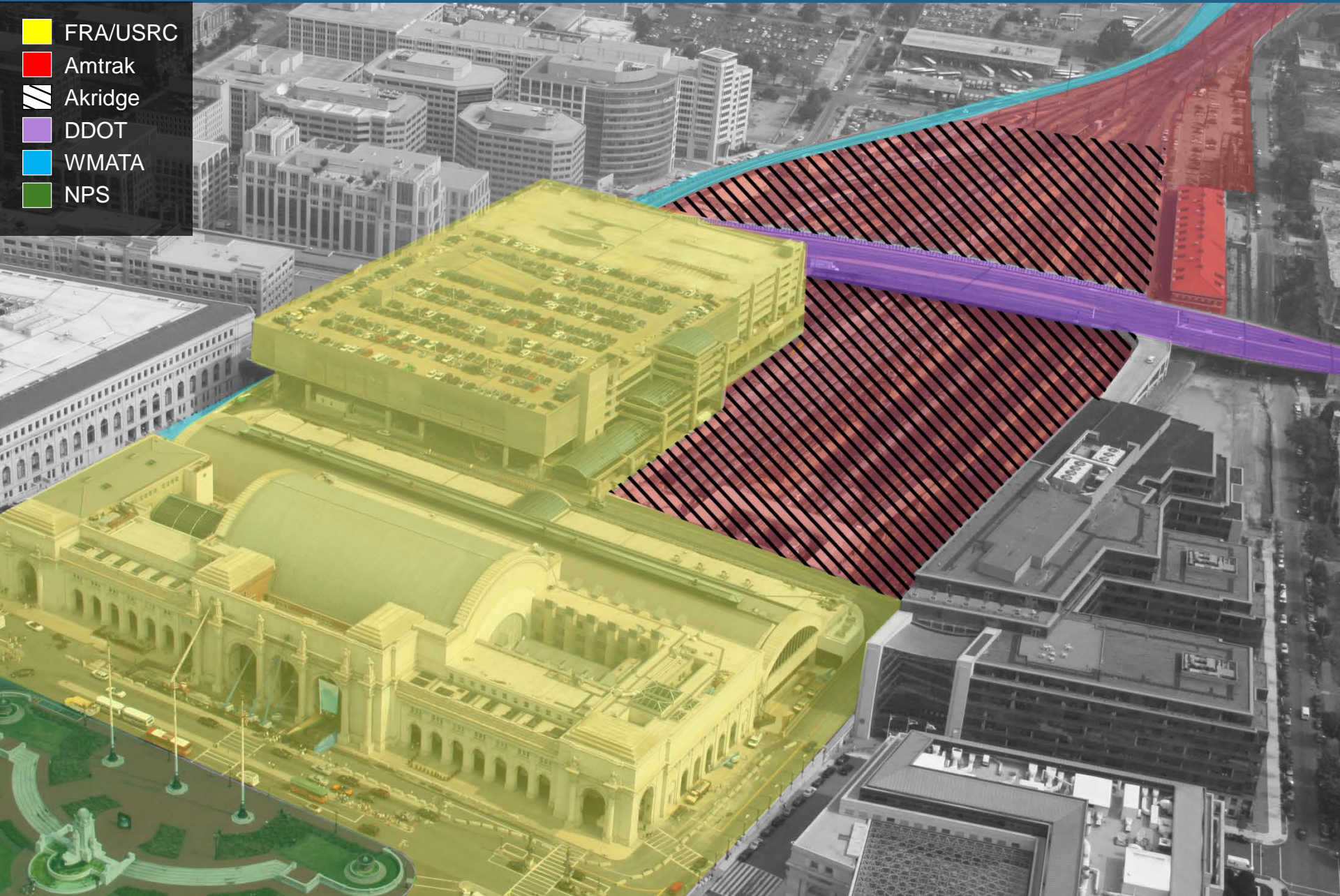

# Project Description

**To expand and modernize Washington Union Station, the National Capital Region's principal multi-modal transportation hub.**





# Project Description

- FRA/USRC
- Amtrak

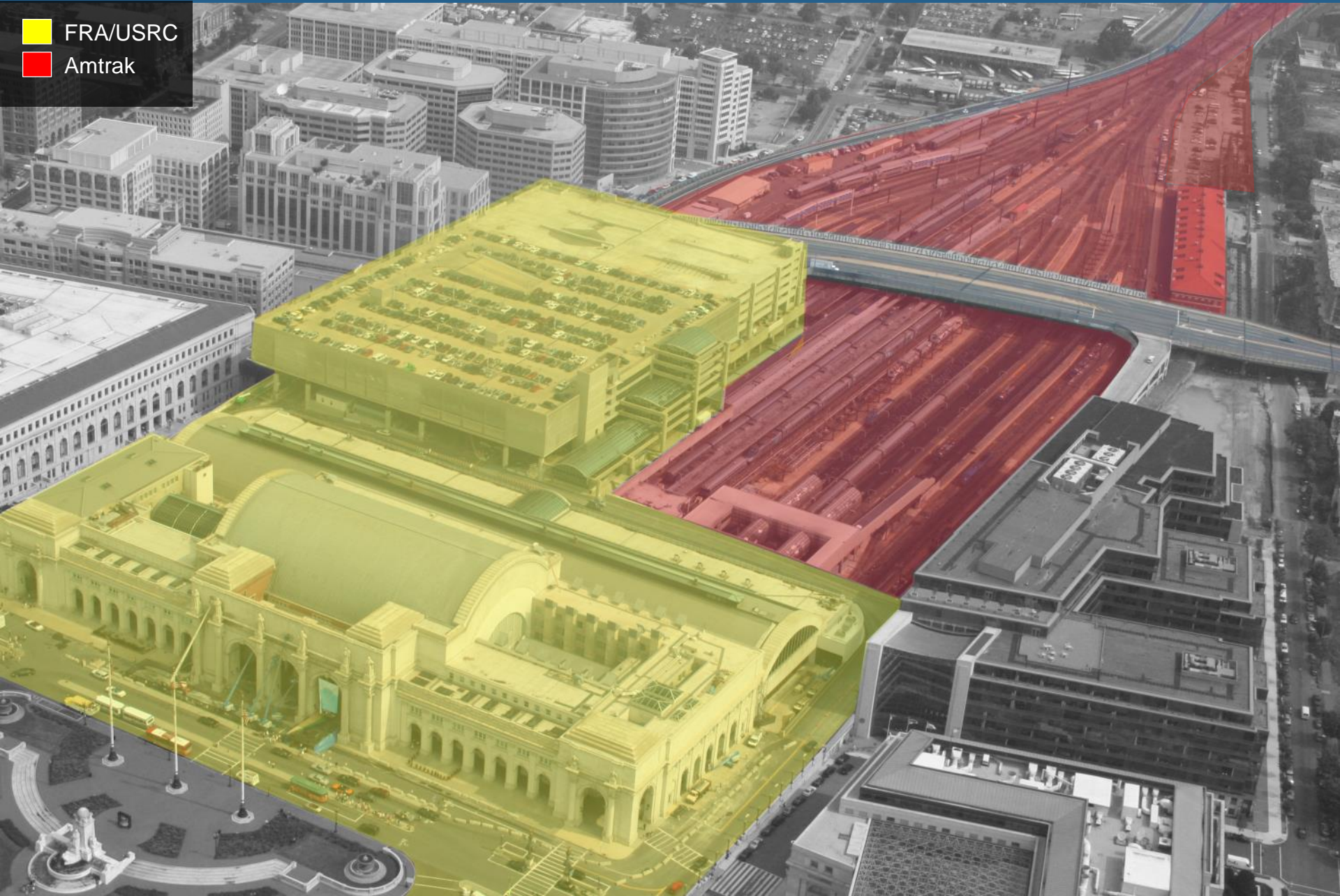

# Project Location

Approximate Project Area



# Project Purpose

- Increase Station capacity to accommodate growth in passenger traffic and railroad operations, and achieving compliance with ADA, security and life-safety standards;
- Maintain financial viability to preserve and maintain the historic Washington Union Station building and its features;
- Provide improved connectivity among transportation modes; and
- Provide better integration between Washington Union Station and its surrounding neighbors and planned land uses.

# Project Need

**Union Station has deficiencies in its current and future operation as a rail station, a multi-modal transportation hub, and an element of the urban fabric providing access to adjacent and surrounding land uses.**

# Project Need

## Rail Needs

- Concourse and gate areas congested under current conditions and do not have the capacity to meet projected future demand
- Platforms and track inadequate to meet future demand
- Some platforms do not meet the requirements of the ADA
- Some platforms and concourses do not meet the requirements of the emergency egress standards



# Project Need

## Rail Needs

- Station does not provide sufficient space to meet future needs for railroad support services and operations
- Station layout does not provide intuitive movement between transit modes

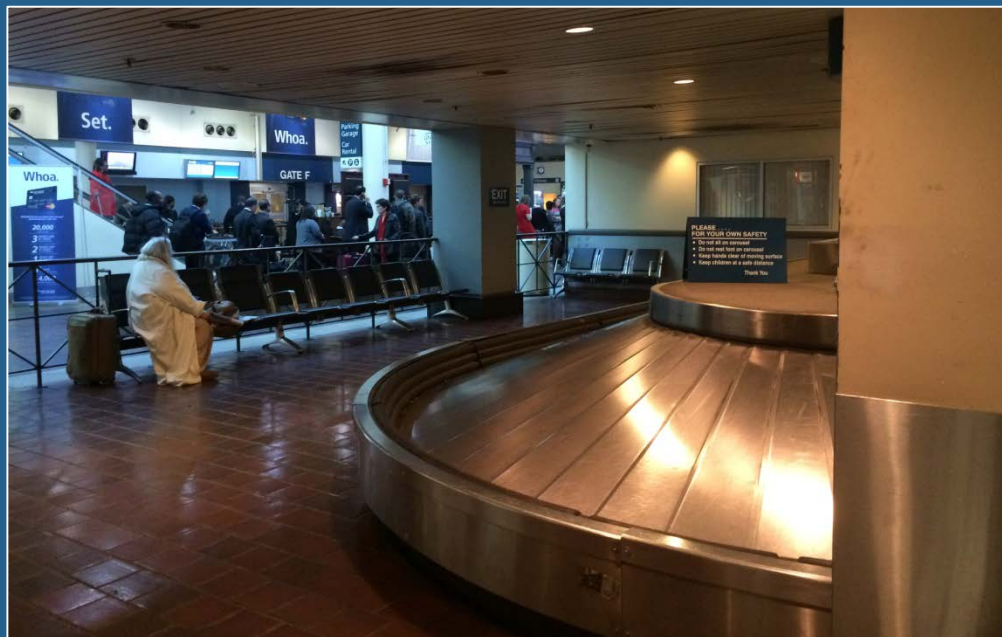

# Project Need

## Other Transportation Modes

- Taxi facilities are inefficient and lack adequate queuing areas
- Metrorail station connections are congested under current conditions and do not have the capacity to meet projected future demand
- Intercity and local bus facilities lack adequate capacity to meet future demand
- Bicycle facilities are limited and lack capacity to meet future demand



# Project Need

## Community

- Union Station provides limited access to and between surrounding neighborhoods and destinations

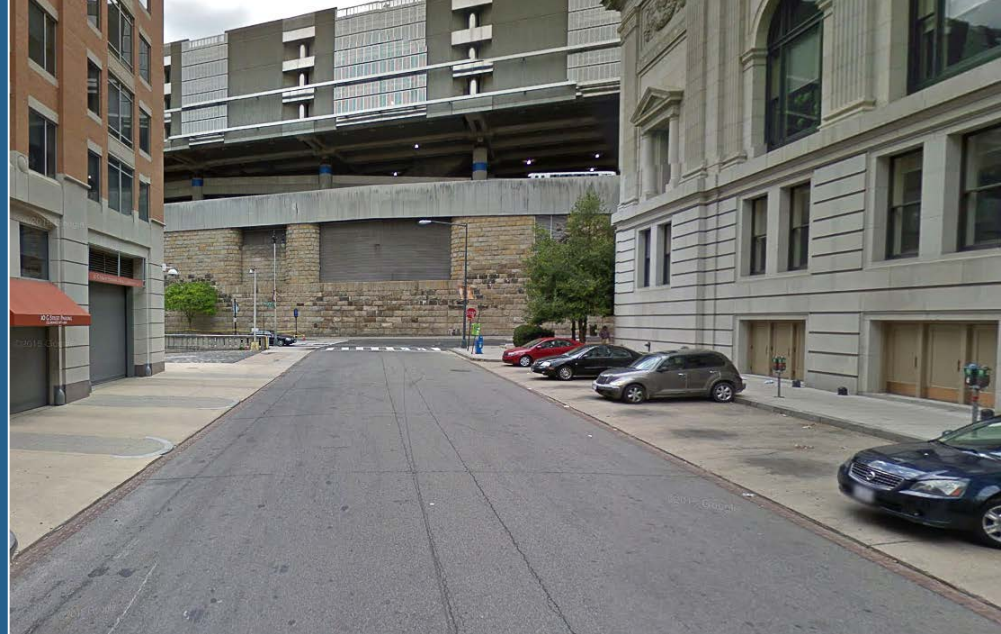



# Elements of the Project

- Tracks
- Concourses
- Station building
- Amtrak service areas and facilities
- Bus terminal
- Taxi facilities
- Parking garage
- Bicycle facilities
- Pedestrian facilities
- Retail



# Washington Union Station Existing Configuration

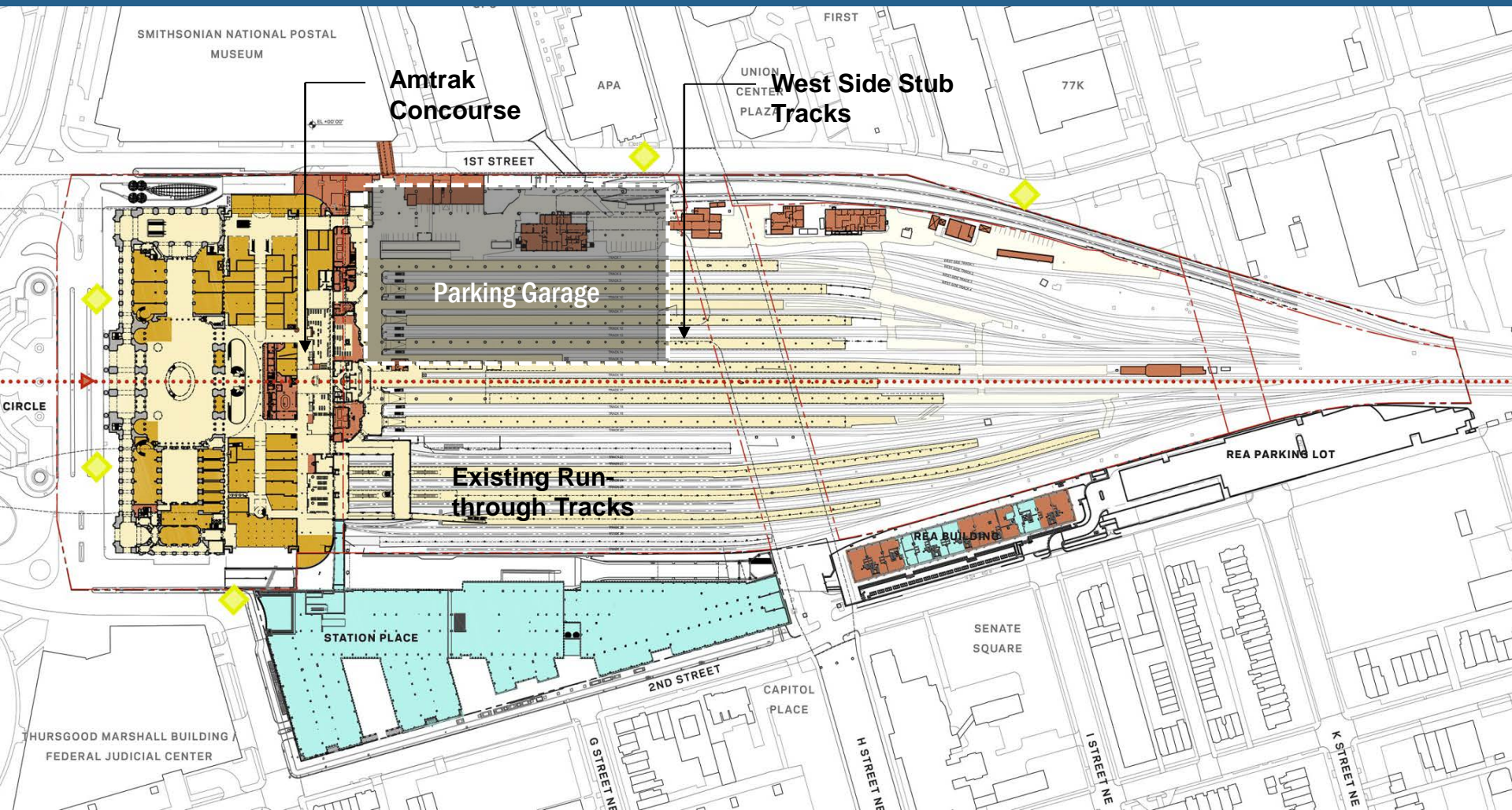

# Existing Elements **HISTORIC STATION BUILDING & CONCOURSE**



# Existing Elements **AMTRAK PASSENGER CONCOURSE**

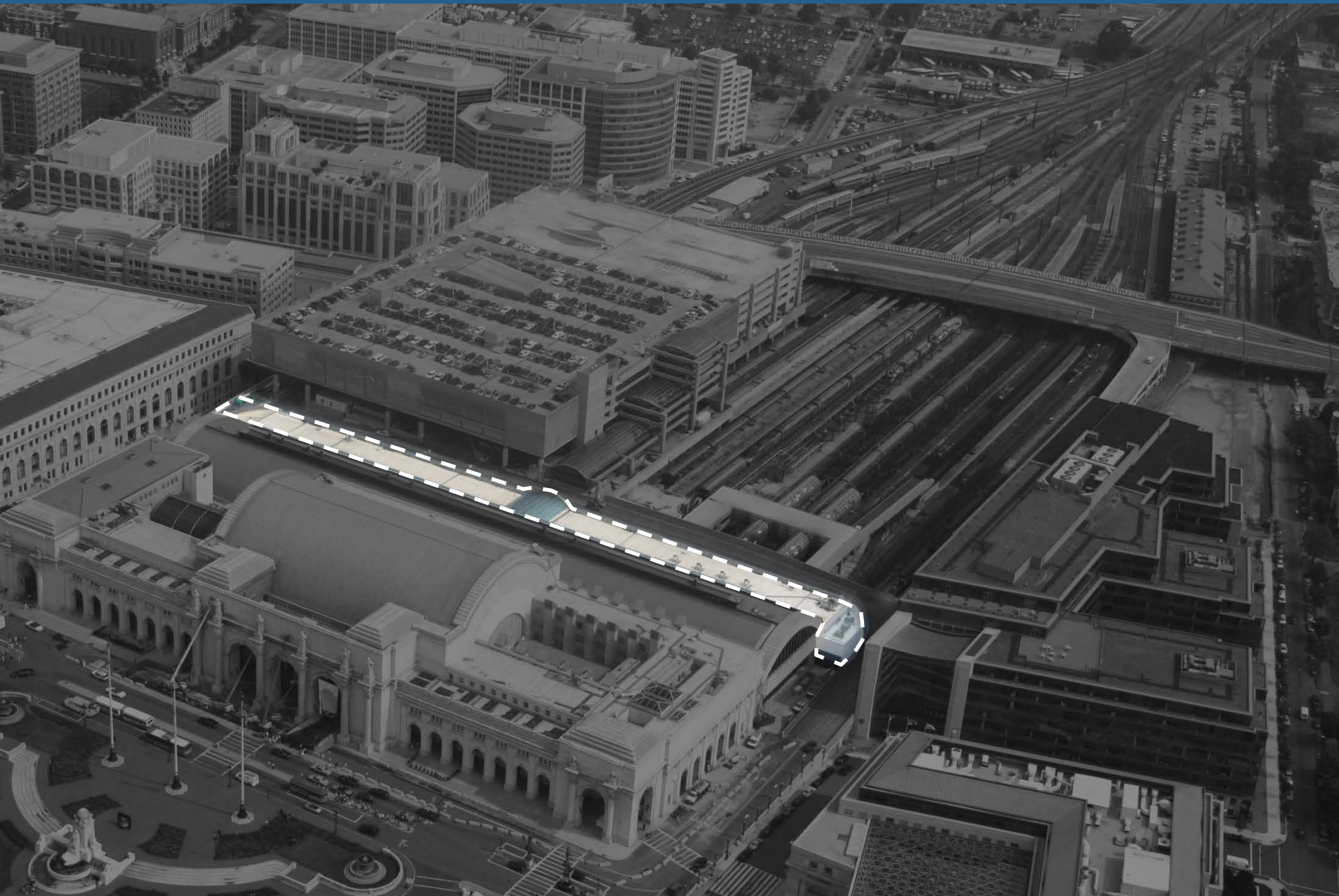

# Existing Elements **RAIL TERMINAL**

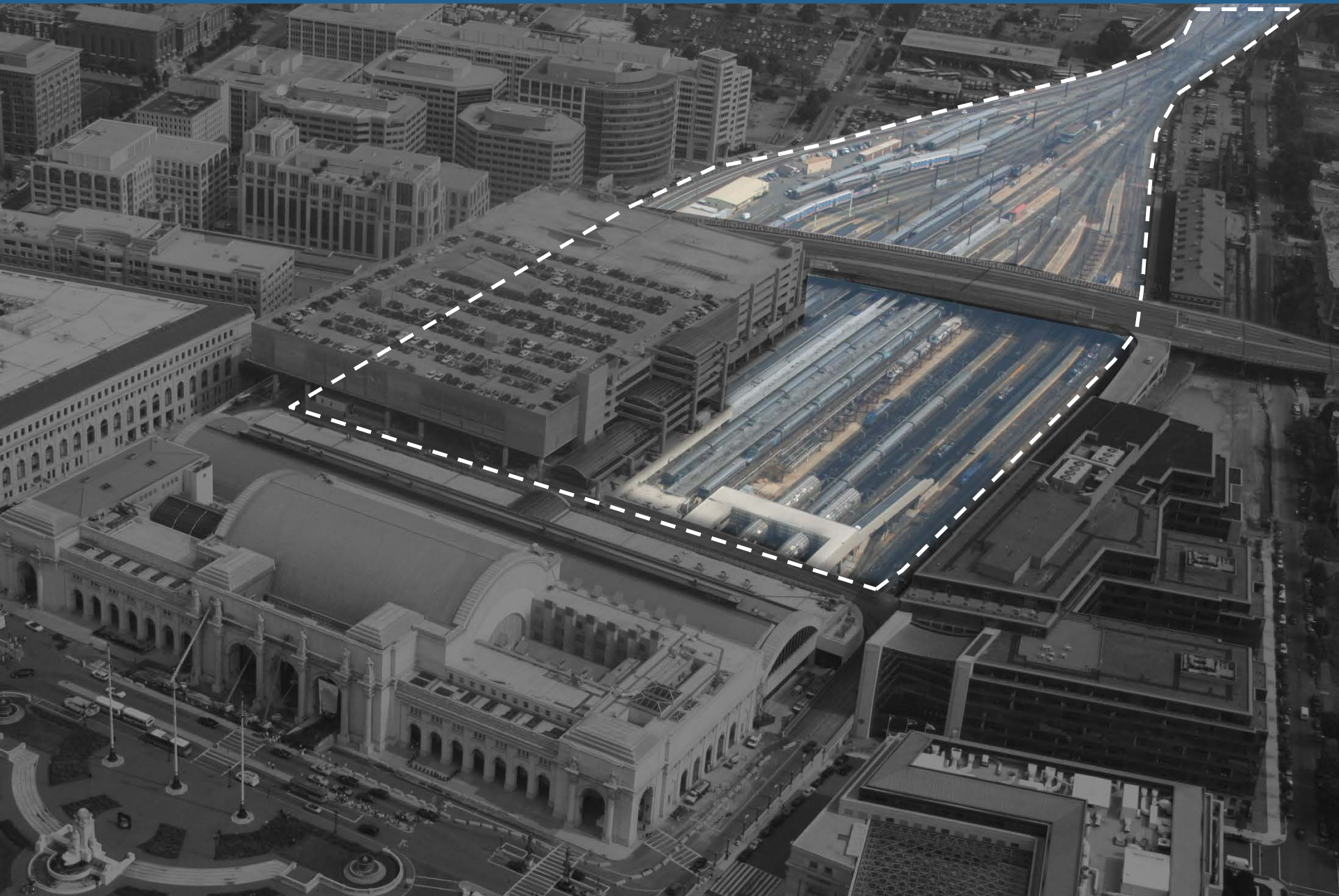

# Existing Elements **PARKING GARAGE AND BUS TERMINAL**

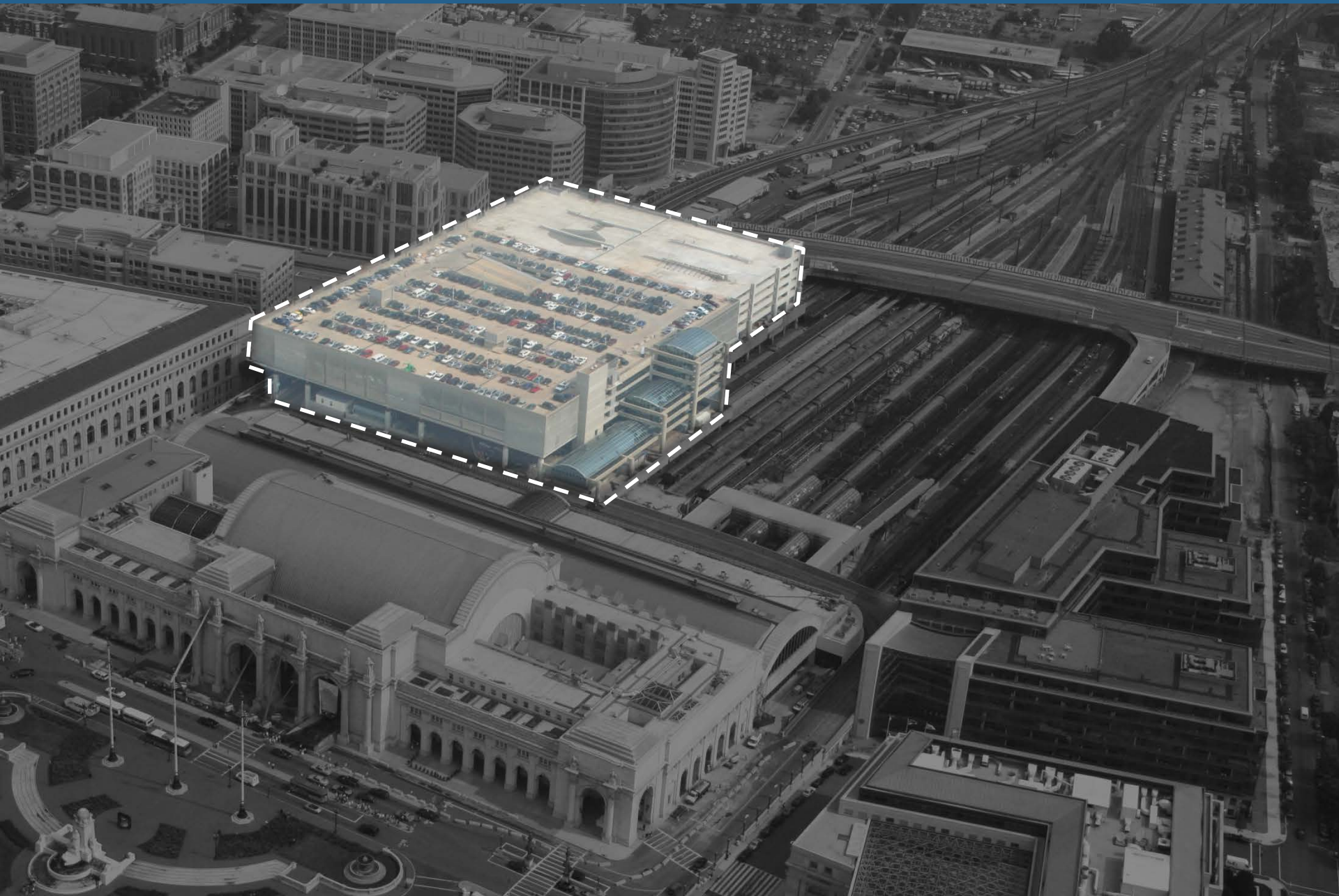

# Existing Elements TAXI, DRIVEWAYS, AND DROP OFF

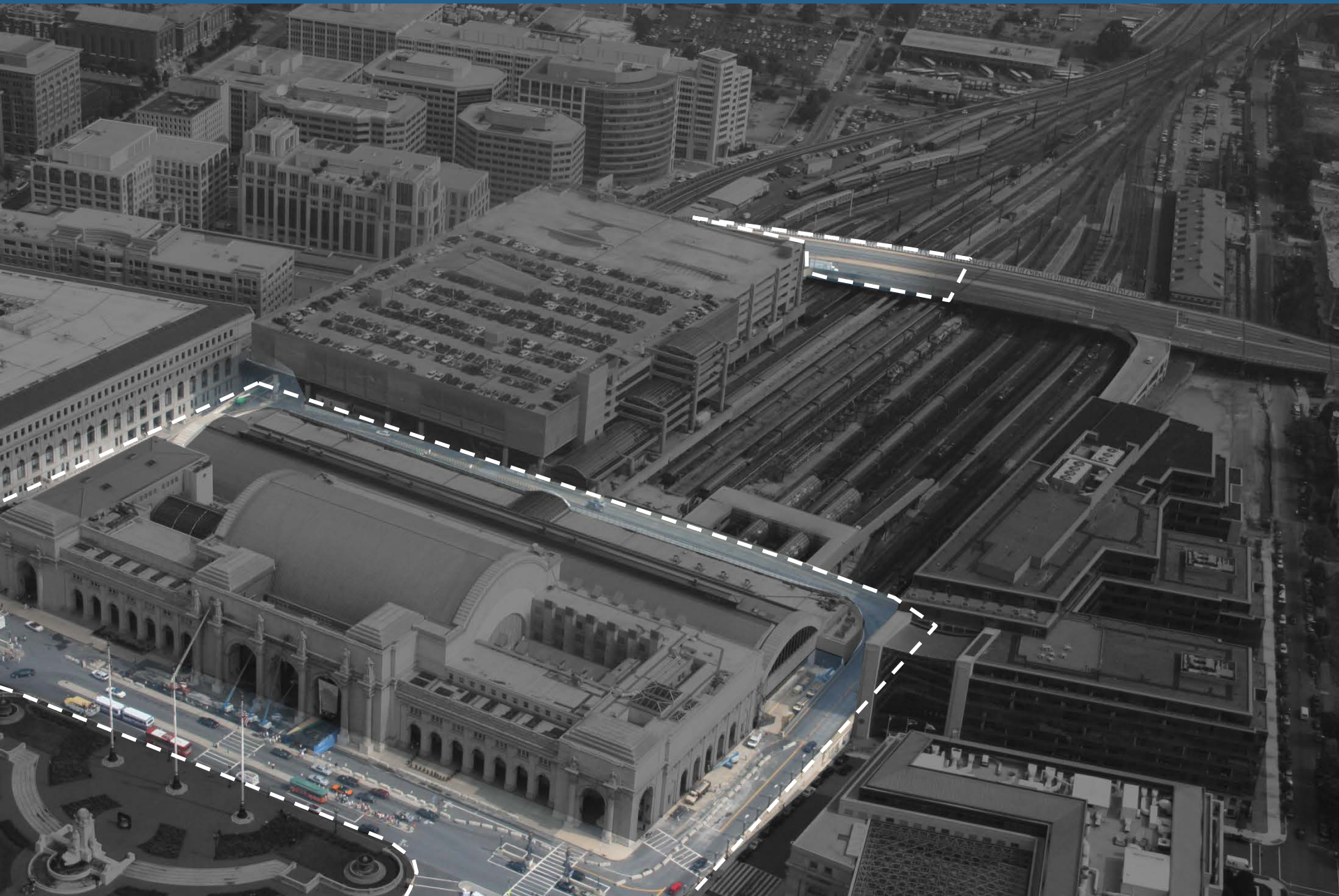

# Existing Elements **PEDESTRIAN ACCESS**





# NEPA & Section 106 Process

NOVEMBER  
2015

DECEMBER  
2015

WINTER  
2016

SUMMER  
2016

SPRING  
2017

FALL  
2017

SPRING  
2018

**Tonight**

Public Meeting #1

Public Meeting #2

Public Meeting #3

Public Meeting #4

Public Meeting #5



- S106**
- Define Undertaking
  - Initiate Consultation

- Identify & Invite Consulting Parties
- Define Area of Potential Effects (APE)

- Identify & Evaluate Historic Properties
- Assess Effects

- Draft MOA or PA to Resolve Adverse Effects

- Execute MOA or PA

# EIS Evaluation Topics

- Air Quality
- Water Quality
- Noise
- Vibration
- Solid Waste Disposal
- Visual / Aesthetics
- Transportation and Traffic
- Land Use
- Social and Economic Effects
- Construction Impacts
- Environmental Justice Communities
- Public Health
- Public Safety
- Parks and Recreational Properties
- Section 4(f) Resources
- Historic Properties
- Secondary Impacts
- Cumulative Impacts

# Public Participation

## Website

U.S. Department of Transportation  
Federal Railroad Administration

Home Page // Rail Network Development // Environment // Current Environmental Reviews // Washington Union Station Expansion Project // Washington Union Station Expansion Project

### Washington Union Station Expansion Project

The Union Station Redevelopment Corporation (USRC) in coordination with Amtrak is proposing to expand and modernize Washington Union Station, the National Capital Region's principal intermodal transportation hub, in order to provide a positive customer experience, support current and future rail service and operational needs; facilitate intermodal transportation; preserve and maintain the historic station and its features; sustain the economic viability of Washington Union Station, and integrate with the adjacent neighborhoods, businesses, and planned development.

#### Environmental Impact Statement

FRA as the lead federal agency will prepare an Environmental Impact Statement (EIS) to evaluate the potential impacts to the human and natural environment resulting from the Washington Union Station Expansion Project. FRA published the **Notice of Intent (NOI)** to prepare the EIS for the Project in the Federal Register on November 4, 2015.

The EIS will be developed in accordance with the Council on Environmental Quality (CEQ) regulations (40 CFR part 1500 *et seq.*) implementing the National Environmental Policy Act of 1969 (42 U.S.C. 4321 *et seq.*) (NEPA) and FRA's Procedures for Considering Environmental Impacts (64 FR 28545, May 26, 1999). In addition to NEPA, the EIS will address other applicable statutes, regulations and executive orders, including the 1980 Clean Air Act Amendments, Section 404 of the Clean Water Act, the National Historic Preservation Act, Section 4(f) of the Department of Transportation Act, the Endangered Species Act and Executive Order 12898 on Environmental Justice. The EIS will provide the FRA, reviewing and cooperating agencies, and the public with information to assess alternatives that will meet the Project's purpose and need, to evaluate the potential environmental impacts; and to identify potential avoidance and mitigation measures.

#### Public Scoping Meeting – December 7, 2015

FRA will hold a public scoping meeting on December 7<sup>th</sup>, 2015 from 4:00PM to 8:00PM in Washington Union Station's Presidential Room. The Meeting will be an open house format for discussions with the Project Team. Two short identical presentations will be given at 4:30 and 7:00 p.m. to provide a project description. The public is encouraged to attend the meeting to learn about the Project and provide input on the purpose and need of the Project, concepts for alternatives that may be considered in the EIS, and the scope of the environmental issues and analyses to be included in the EIS.

#### Scoping Comments

- Public Meetings

- Comments

- Written

- Via Email

- Website

[www.fra.dot.gov/Page/P0866](http://www.fra.dot.gov/Page/P0866)

- Email Address

[info@WUSstationexpansion.com](mailto:info@WUSstationexpansion.com)

# Purpose of Public Scoping Meeting

**FRA requests your input on what issues and resources that are important to you. The Scoping process will help inform the next steps in the process including:**

- Purpose and Need for the Project
- Study area
- Issues and resources to be evaluated in the EIS
- Project elements to be considered in the alternatives
- Potential project impacts

# Scoping Comments

To learn more about the project and ask questions, please visit the project representatives at each of the stations located around the room.

Provide all comments either by filling out a comment card here or by email.

**Comments Due by  
January 4, 2016**

Email comments to:  
[info@WUSstationexpansion.com](mailto:info@WUSstationexpansion.com)

**Or to FRA:**

Michelle W. Fishburne, PE  
Office of Railroad Policy and  
Development  
USDOT Federal Railroad  
Administration  
MS-20 RPD-13  
1200 New Jersey Ave. SE  
Washington DC 20590