

2016 **FRA** Rail Program Delivery Meeting

Building the Rail Network

Paul Nissenbaum

Associate Administrator for Railroad Policy & Development

Agenda

- **Milestones and Project Improvements**
- **Legislative Highlights**
- **Looking to the Future – Pipeline and Regional Planning**
- **Multimodal Planning and Partnerships**



FEDERAL RAILROAD ADMINISTRATION

ARRA/FY10 Rail Funding - \$10.1 Billion Portfolio

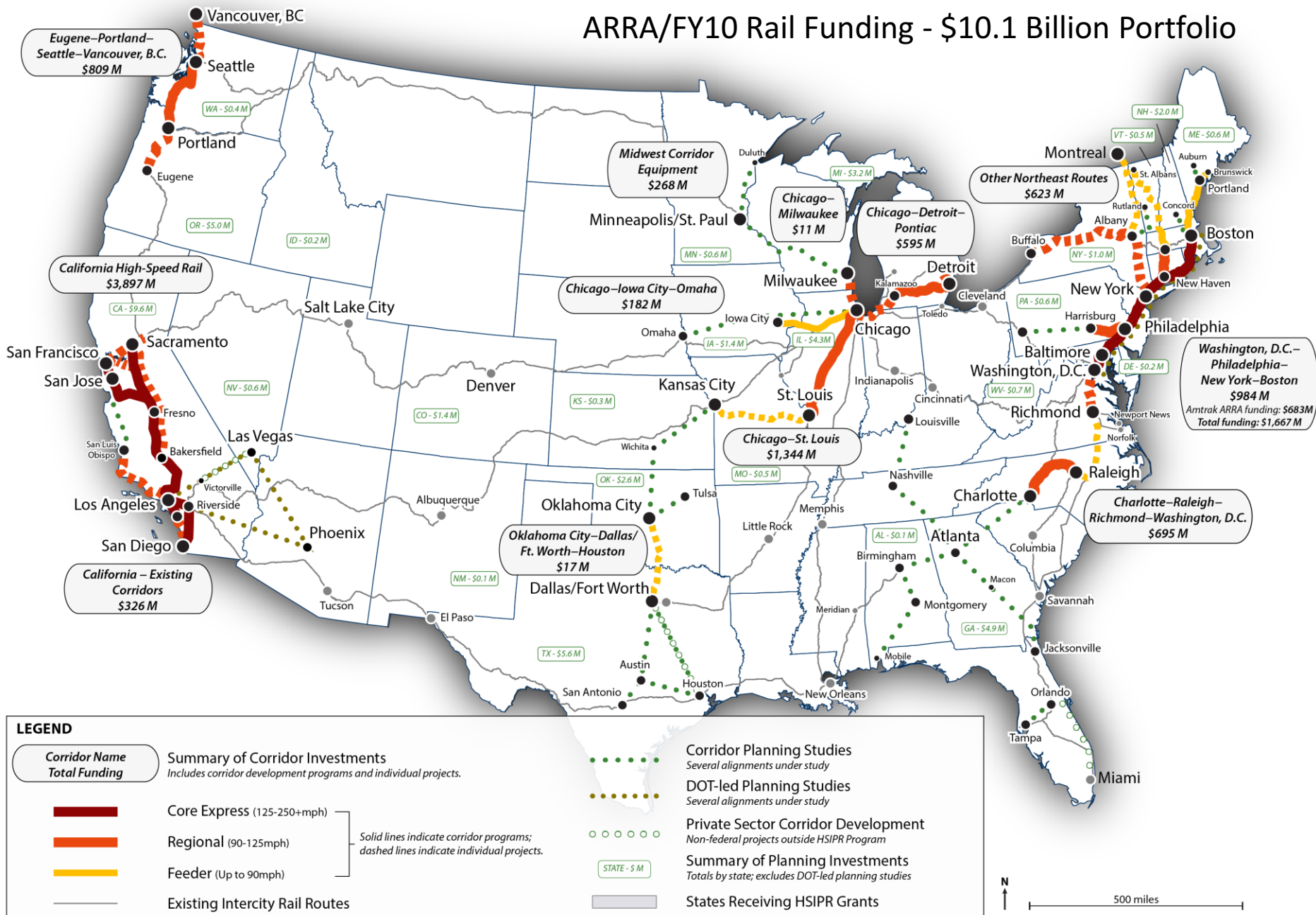

Downeaster-Portland North Project (ME)

Brunswick Maine Street Station

Before: Vacant lot, no train service

(Photo via Google Street View)



After: New development, active station

(Photo via Google Street View)



NCDOT Piedmont Third and Fourth Frequency Program (NC)

**Before: Single track from CP
Graham to Haw River**



After: New passing siding



Normal Multimodal Transportation Center (IL)

Before: 1990 station

(Photo by Mark Ciskey via www.hebners.net)



After: Renovated and active station

(Photo by Brad Basham via www.normal.org)

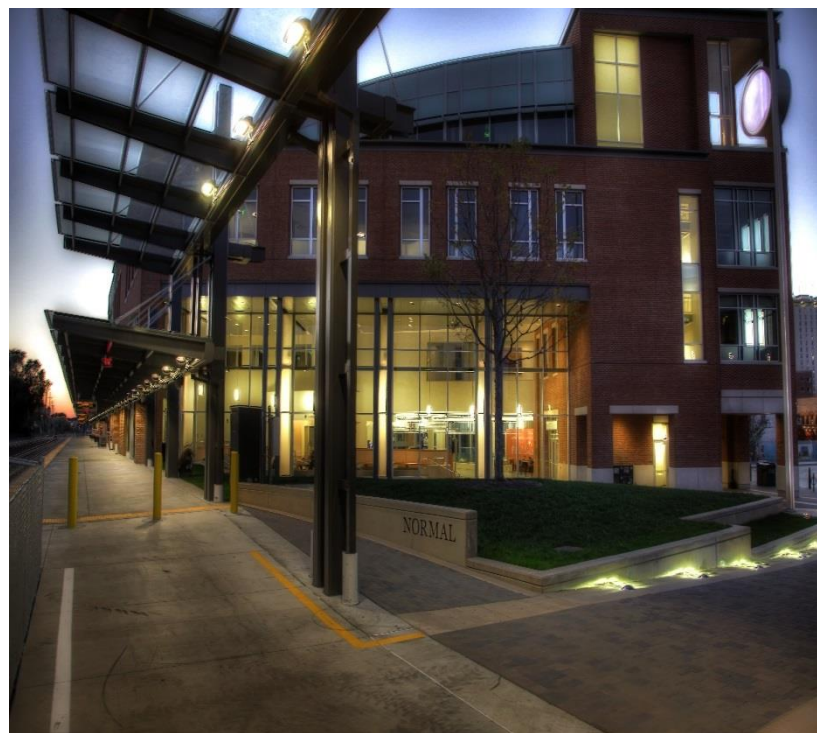

Dearborn Intermodal Rail Facility (MI)

Before: 1970s one-platform station

(Photo by Dwight Burdette via Wikimedia commons)



After: Modern two-platform station

(Photo via www.railfanguides.us)

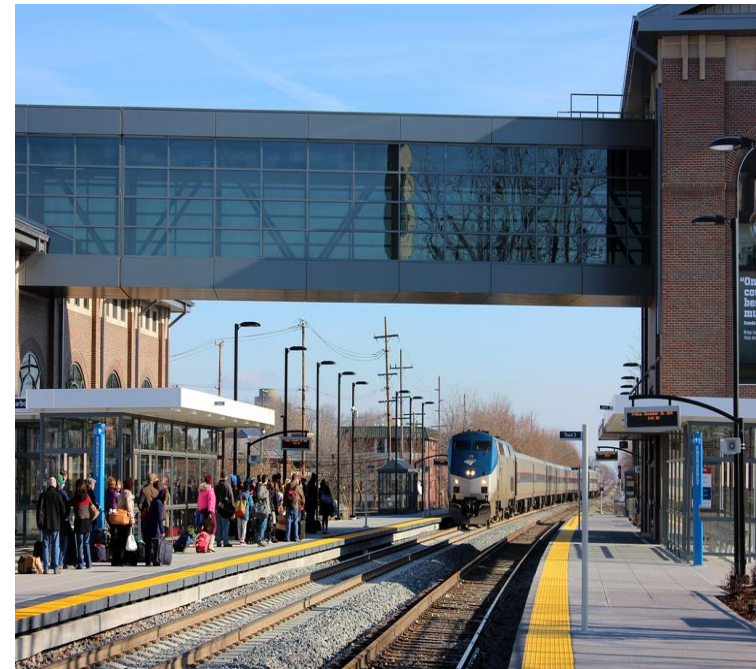

Sacramento Intermodal Facility Phase 1 - Track Relocation Project (CA)

Before: Outdated, narrow platforms

(Photo by Jeremiah Cox via SubwayNut.com)



After: Wider platforms, more capacity

(Photo via www.acm.jhu.edu/~sthurmovik/Railpics)



Pacific Northwest Rail Corridor (WA)

Before: Delta Yard tracks in Everett in Washington

(Photo by Washington State Department of Transportation)



After: Two new tracks added allowing trains to move with less interference.

(Photo by Washington State Department of Transportation)



Current Rail Funding Opportunities

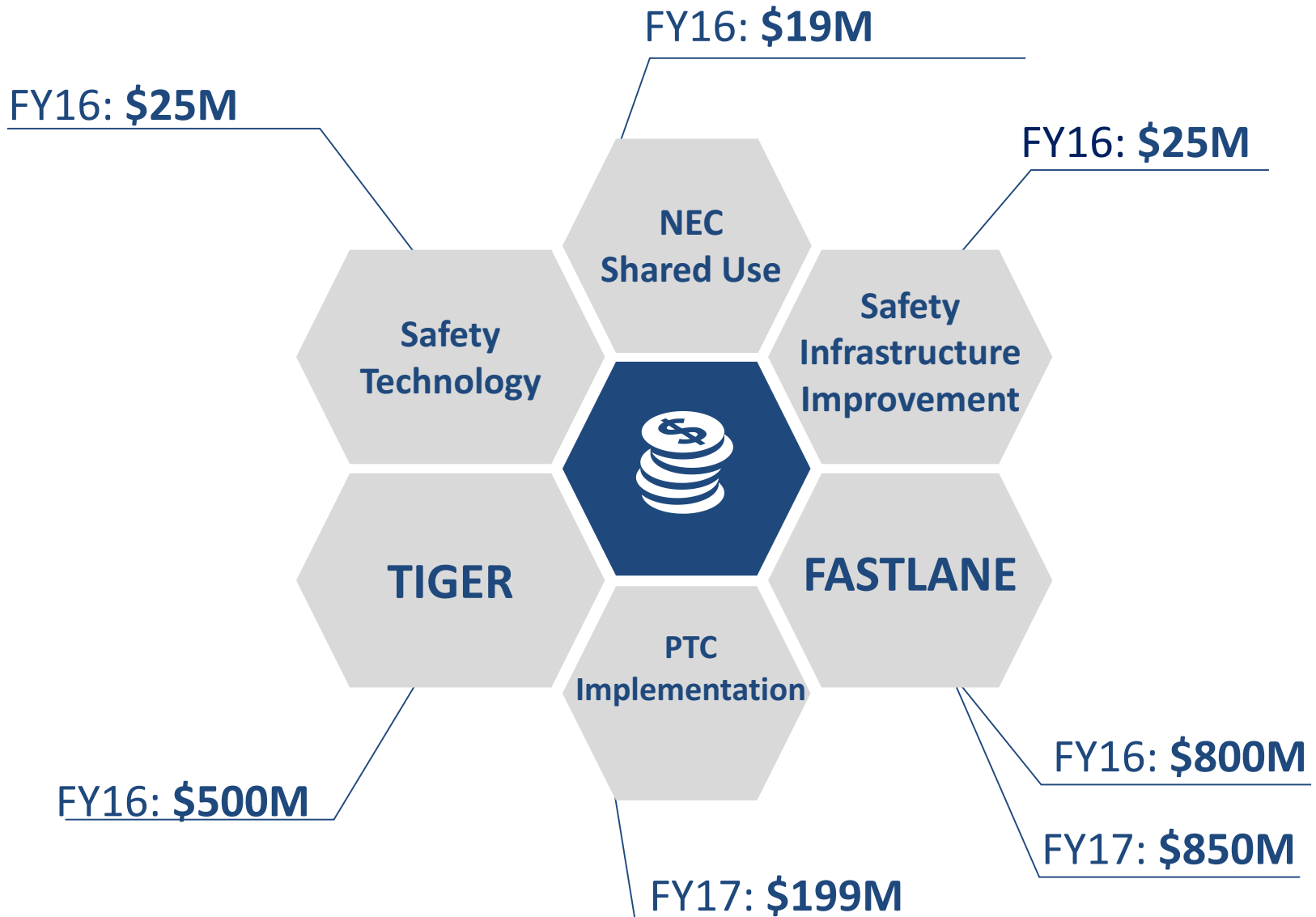

Major FAST ACT Grant Programs

FAST Act Authorized Funding*

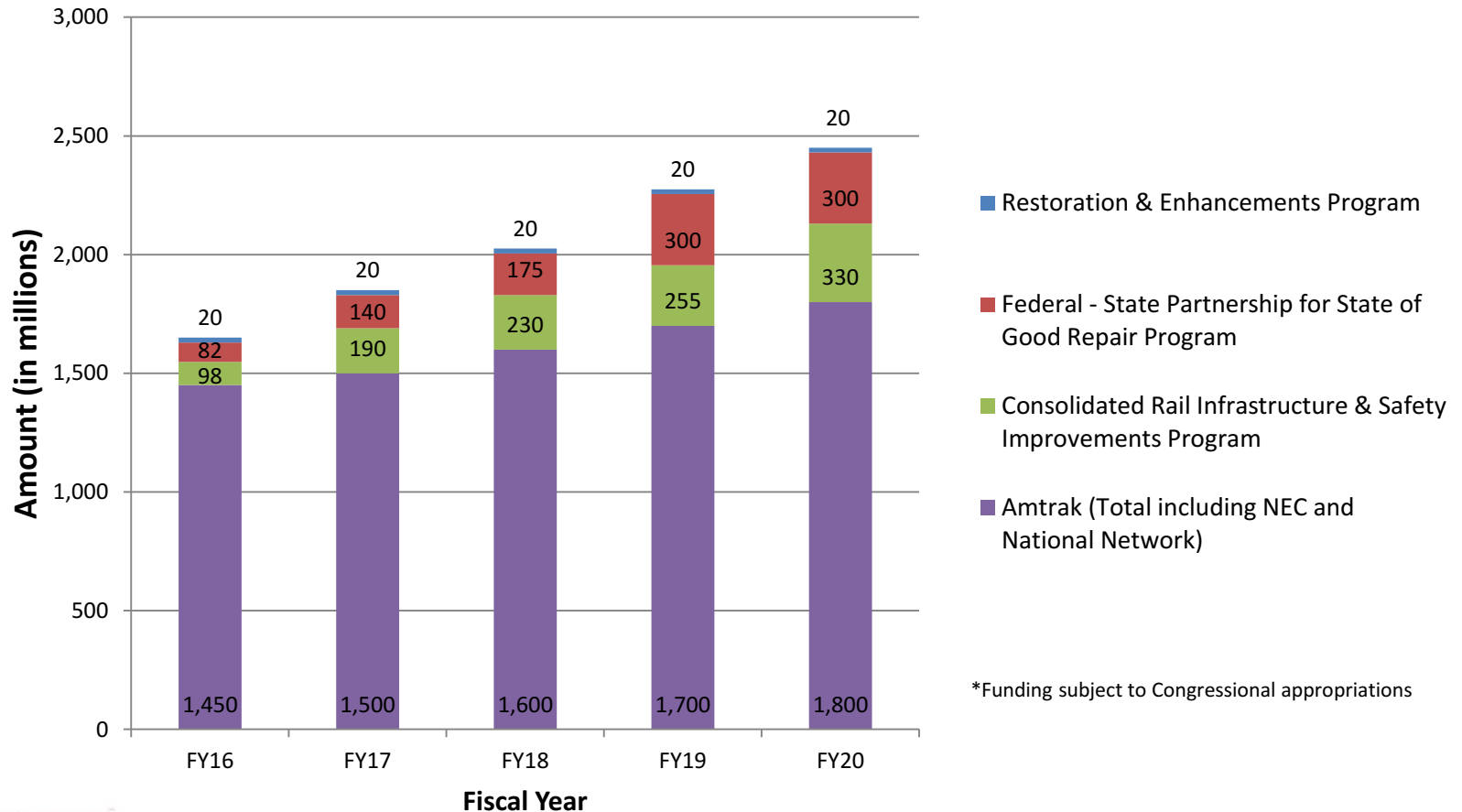

FRA – Office of Railroad Policy and Development

11/29/2016

Shared-Use

Shared-Use Study

Collaborating with Amtrak, commuter/freight railroads, state/local governments, to address far-reaching implications on past, present, and future performance of passenger and freight transportation

Study will address:

- Access and use of host RR ROW
- Train performance standards
- Measuring public benefits
- Modeling
- Liability



FRA's Passenger Rail Development Pipeline

Since 2009, \$371M in combined Federal and additional State/private funds have been building a “pipeline” of future projects.

- Prepare for future funding availability – *what are the best market-based investments?*
- Determine priorities for next round of planning – *what potential markets are still “missing”?*
- Identify national vision – *where is rail heading in the U.S.?*



FEDERAL RAILROAD ADMINISTRATION



FRA – Office of Railroad Policy and Development

11/29/2016



U.S. Department
of Transportation
**Federal Railroad
Administration**

FEDERAL RAILROAD ADMINISTRATION



FRA – Office of Railroad Policy and Development

11/29/2016



U.S. Department
of Transportation
**Federal Railroad
Administration**

FEDERAL RAILROAD ADMINISTRATION



FRA – Office of Railroad Policy and Development

11/29/2016



U.S. Department of Transportation
Federal Railroad Administration



U.S. Department
of Transportation
**Federal Railroad
Administration**

FEDERAL RAILROAD ADMINISTRATION



FRA – Office of Railroad Policy and Development

11/29/2016



U.S. Department of Transportation
Federal Railroad Administration

FEDERAL RAILROAD ADMINISTRATION

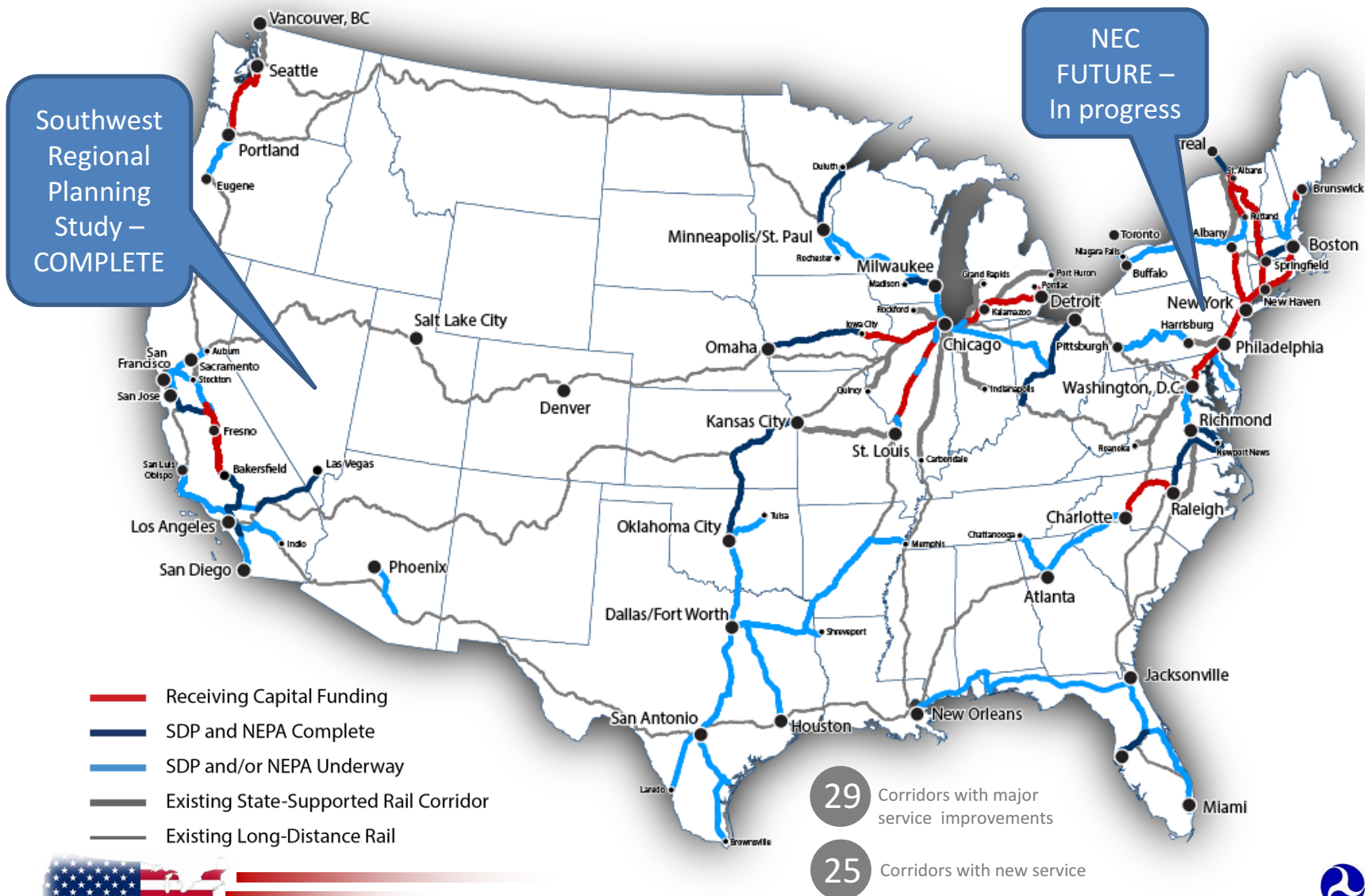

FRA – Office of Railroad Policy and Development

11/29/2016



U.S. Department of Transportation
Federal Railroad Administration

FEDERAL RAILROAD ADMINISTRATION

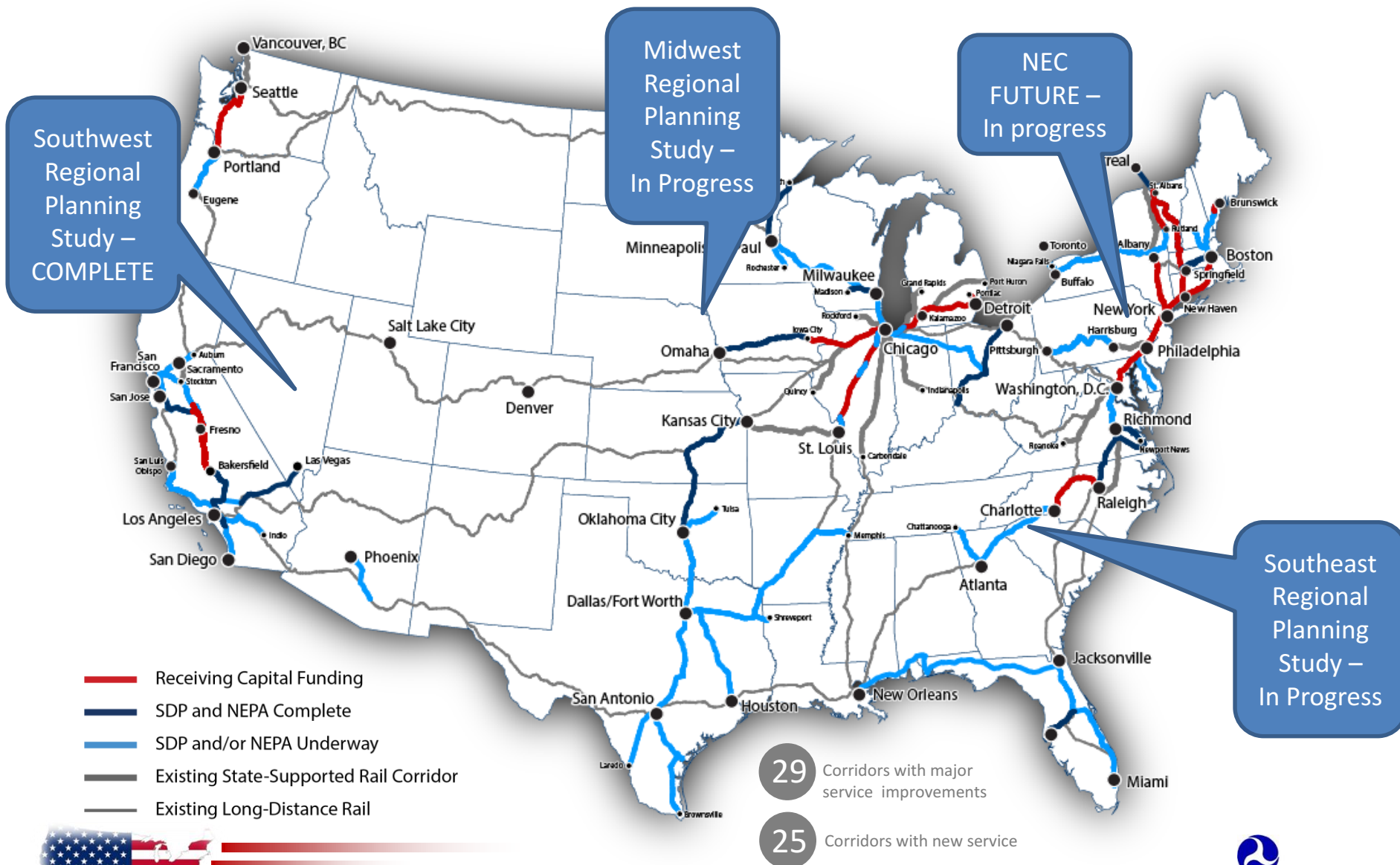

FRA – Office of Railroad Policy and Development

11/29/2016

Intermodal Connections

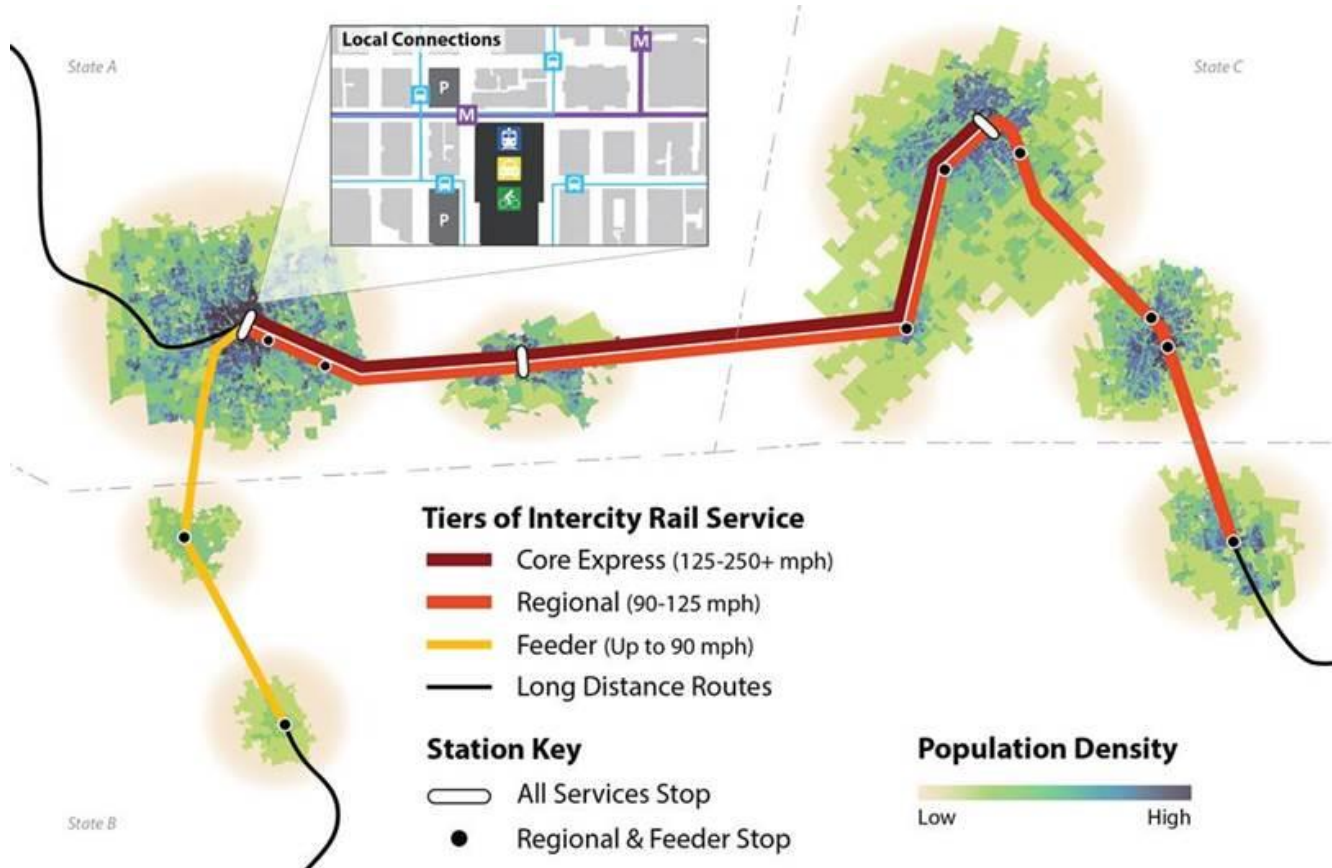

Modal Collaboration

- Financial assistance programs
- Regulatory harmonization

Building the Rail Network Panel Discussion



FRA – Office of Railroad Policy and Development

11/29/2016



U.S. Department
of Transportation
**Federal Railroad
Administration**